

Civic - Transportation Air & Ground



PROJECT LIST

Representative Project Experience

Capital has provided professional engineering consulting services throughout California and Northern Nevada since 1947. Over the past 7 decades, Capital has developed strong relationships with architects, owners, construction managers, and contractors involved in the design and construction of both air and ground transportation. Capital is very familiar with the unique challenges and broad impact that can occur with all transportation facilities projects.



Los Angeles World Airport Midfield Satellite Concourse, Los Angeles

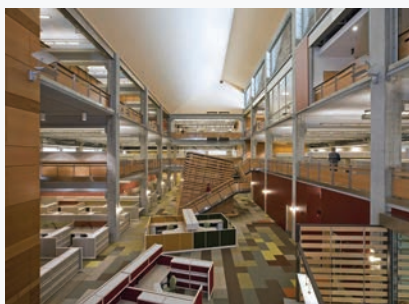

AIR TRANSPORTATION

» Los Angeles International Airport

- Midfield Satellite Concourse
- Terminal 4 Connector
- Central Utility Plant Commissioning
- Sacramento International Airport
- Administration
- Ancillary Buildings
- Baggage Claim Addition and Screening
- Computer Room Revision
- Concourse TI
- Custodial Staff Area
- Fire Station
- Fuel Station Modifications
- Garage Escalator
- International Arrivals
- LLAB/ETB Modifications
- Maintenance Facility
- Master Plan Tasks A,B, C, & F
- Materials Testing Lab
- Modernization Tasks G, H and I
- On-Call Engineering Services
- Parking Structure
- Pedestrian Bridges
- PMAE Building
- Public Safety Building
- Remote Central Receiving Facility
- Telecommunications Upgrade

» Sacramento International Airport Terminal A

- Capital Marketplace
- Computer Room HVAC/Fire Sprinkler Remodel
- Garage Link CA
- La Bou Remodel
- Parking Garage

- PGA Tour Shop TI
- Remodel for Airline Moves
- Travelmart

» Sacramento International Airport Terminal B

- Airside Concourse
- Burgers & Brew TI
- Cogen CD & CA
- DD Airside/Terminal Building TI
- DD Existing Facilities
- DD Pack Ancillary Building
- DD Package Civil/Site
- DD Package Concessions
- DD Package Cost Estimating
- DD Package Hotel
- Escape Lounge
- Esquire Grille TI
- Landside Terminal
- Storage TI

» Sacramento Metropolitan Airport

- Ceiling Replacement
- Central Plant Capacity Study
- Concourse
- Cooling Tower Study
- CPS Pump Upgrade II
- East Terminal TES Study
- Host Hotel Drain Pumps
- New East Terminal Building
- Rental Car Building
- Terminal Gas Cooling Study

» Additional Projects

- Beale AFB Transportation Building HVAC
- Mather Airport Fire Sprinkler for Hangers 7005, 7010, 7035, Sacramento
- Sacramento County Executive Airport Main Terminal Building HVAC System Upgrades and Design, Sacramento

bring
life to
buildings™

Civic - Transportation Air & Ground



PROJECT LIST



Continued...

- San Jose Airport, Alaska Air Inflight Lounge and American Airlines Lounge Remodel
- Santa Barbara Airport Delta Airlines Remodel
- Truckee Tahoe Airport Terminal Building, Truckee

GROUND TRANSPORTATION

- » AC Transit D3 Richmond Yard Reactivation, Richmond
- » Amador Unified School District Transportation Center, Sutter Creek
- » BART Underpass Safety Walkway, San Francisco
- » Beale AFB Transportation Building HVAC
- » Caltrans District 3 Office Building, Marysville
- » Caltrans Maintenance Station, Fremont
- » Caltrans Maintenance Station, Oroville
- » Caltrans Maintenance Station, Susanville
- » Carnegie State Vehicular Recreation Area Maintenance Shop Expansion, Tracy
- » City and County of San Francisco Fleet Maintenance and Operations Management Department
- » City of Modesto Fleet Maintenance Facility Truck and Automotive Service Facility
- » City of Roseville Railyards Infrastructure and Shops Renovation, Sacramento
- » City of Roseville Transportation Office
- » Courtland School District Bus Garage, Courtland
- » Elk Grove Unified School District Corporation Yard and Bus Garage
- » Eureka Union School District Resource and Transportation Office, Roseville
- » Livermore Amador Valley Transit Authority Bus Fuel and Wash, Livermore
- » Mammoth Unified School District Transportation Center, Mammoth Lakes
- » Mather AFB Vehicle Maintenance Facility
- » North Tahoe Public Utility Department Operational and Maintenance Headquarters, Tahoe Vista
- » Pittsburg Unified School District Maintenance, Operations and Transportation Yard Modernization
- » Placer County Auburn Justice Center Operations and Maintenance Evaluation
- » Placer County CNG Vehicle Maintenance Facility Assessment & Feasibility Study, Auburn
- » Placer County Finance Administration Building Maintenance Evaluation, Auburn
- » Roseville Unified School District Transportation Facility, Roseville
- » Sacramento County Conservation Road Fuel Station Modifications
- » Sacramento Regional Transit Building Tenant Improvement
- » Sacramento Regional Transit Bus Maintenance Facility II, Sacramento
- » Sacramento Regional Transit Bus Maintenance Paint Ventilation Upgrades, Sacramento
- » Sacramento Regional Transit Hydronic Line Relocation, Sacramento
- » Sacramento Regional Transit Instrument House, Sacramento
- » Sacramento Regional Transit South Area Stations, Sacramento
- » Sacramento Regional Transit SSCP-2-CRC Station, Sacramento
- » Sacramento State Vehicle Maintenance Shop, Sacramento
- » San Joaquin Regional Transit District Regional Transportation Center, Stockton
- » San Juan Unified School District Bus Maintenance Facility, Carmichael
- » Stanislaus County Vehicle Maintenance Facility New Maintenance Building, Modesto
- » Stockton Post Office Vehicle Maintenance Facility
- » Stockton Rail Depot Remodel and Savings By Design, Stockton
- » Stockton Unified School District New Bus Maintenance Facility, Stockton
- » UC Davis Advanced Transportation Infrastructure Research Center (ATIRC), Davis
- » Union Sanitation District Corporation Yard, Union City
- » West Sacramento Post Office Maintenance Facility
- » WestCAT Bus Operation & Maintenance Facility Expansion, Pinole
- » Yuba City Transit Bus Maintenance Facility

bring
life to
buildings™